

# Xplore C1+

## Quick Start Guide

### Smart Dashcam

[www.amacam.net](http://www.amacam.net)  
[support@amacam.net](mailto:support@amacam.net)

#### / IN YOUR CAR

1 Clean the windshield and choose a position where the Dashcam will not block the driver's view. A recommended place is behind the rear view mirror. Place windshield sticker.

Tip: Put the hexagon mouth of sticker upside-down.

2 Insert a Memory Card (SDHC Class 10 or above) into the Dashcam.

3 Mount the Dashcam onto the Bracket.

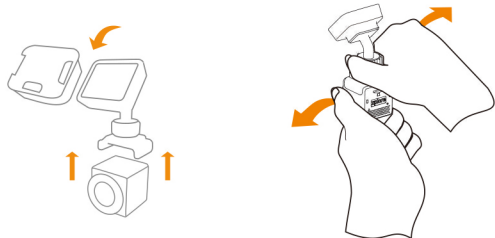

#### / HELLO

Thanks for choosing Xplore C1+ Dashcam.

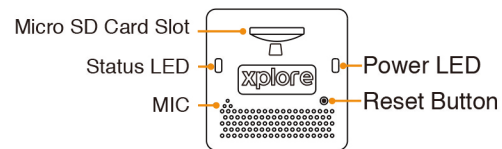

| Status LED             |             | Power LED          |             |
|------------------------|-------------|--------------------|-------------|
| Recording              | GREEN       | Low Power 10%      | RED Flash   |
| Recording / Card Error | OFF         | Low Power 20%      | RED         |
| Snapshot               | GREEN Flash | Charging           | BLUE Flash  |
| WiFi Error             | RED         | Full (Charged)     | GREEN       |
| GPS Error              | YELLOW      | Upgrading Firmware | GREEN Flash |
| Snapshot Remote Error  | BLUE        |                    |             |

#### / TURN ON AND OFF

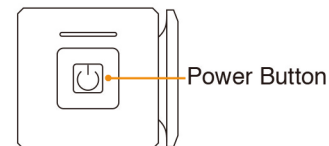

**AUTOMATIC**  
 Xplore C1+ Dashcam starts recording when the engine starts, and powers off 20 seconds after the engine stops.

**MANUAL OVERRIDE**  
 Turn ON: Hold the Power Button for 2 seconds.  
 Turn OFF: Hold the Power Button again for 3 seconds.

**SNAPSHOT MODE**  
 When recording, press the Power Button. Xplore C1+ takes a picture and saves a 12 second video clip.

#### / Xplore C1+ APP

Go to our website at [www.amacam.com](http://www.amacam.com) to download the App, or search for xploreCam on the AppStore or Google Play.

#### / SNAPSHOT REMOTE PAIRING

The Snapshot Remote will automatically pair with the Dashcam and Bluetooth are switched on. (In exceptional cases you may have to hold down the switch on the Snapshot Remote for 3 seconds to compel it pair again.)

#### / WIFI CONNECTION

Switch on your smartphone's WiFi. Search for SSID 'XPLORE\_XXXXXX' to connect. The initial password is 12345678.

#### / IN THE BOX

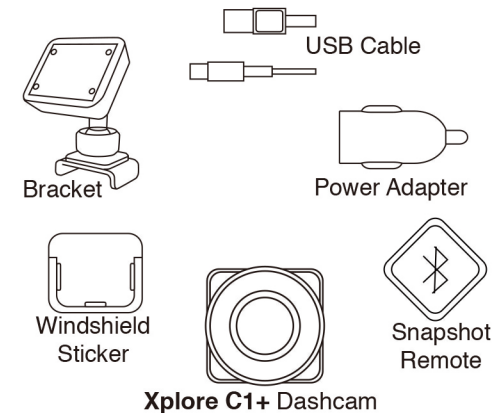

#### / IN YOUR CAR

1 Clean the windshield and choose a position where the Dashcam will not block the driver's view. A recommended place is behind the rear view mirror. Place windshield sticker.

Tip: Put the hexagon mouth of sticker upside-down.

2 Insert a Memory Card (SDHC Class 10 or above) into the Dashcam.

3 Mount the Dashcam onto the Bracket.

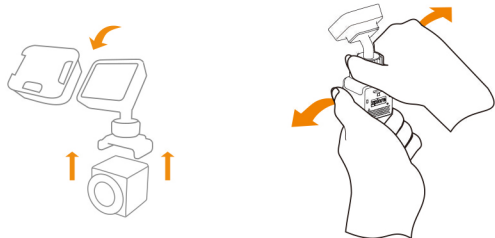

- 4 Fix the Bracket to the Windshield Sticker.
- 5 Fit the USB Cable to the Bracket and fix Cable in car. (The cable can be hidden and fixed with cable clips if desired).
- 6 Plug in the Power Adapter to the car's cigar lighter.
- 7 Insert USB Cable into Power Adapter.
- 8 Your Xplore C1+ is ready to go.

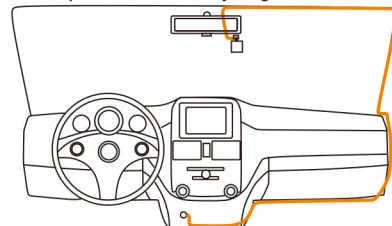

#### / Xplore C1+ APP

Go to our website at [www.amacam.com](http://www.amacam.com) to download the App, or search for xploreCam on the AppStore or Google Play.

#### / SNAPSHOT REMOTE PAIRING

The Snapshot Remote will automatically pair with the Dashcam and Bluetooth are switched on. (In exceptional cases you may have to hold down the switch on the Snapshot Remote for 3 seconds to compel it pair again.)

#### / WIFI CONNECTION

Switch on your smartphone's WiFi. Search for SSID 'XPLORE\_XXXXXX' to connect. The initial password is 12345678.

#### / FAQs

- 1 **Dashcam won't record**  
 Make sure you are using a SDHC rapid storage card (Class 10 or above) from an authorized seller. Check if there's enough space on the memory card. Format the card if necessary.
- 2 **Dashcam is hot**  
 Heating is normal, and the normal operating temperature is between -20°C and 70 °C.
- 3 **Dashcam has crashed**  
 Use a paperclip to press the Reset Button.
- 4 **What's the maximum capacity of memory card?**  
**When can a memory card be inserted or removed?**  
 32 GB. Insert and remove the memory card when Dashcam is turned off.
- 5 **What's seamless loop recording?**  
 When the memory card is full the Dashcam will automatically overwrite from the earliest recording. Protected files and emergency recording will not be overwritten.